

ISOMAG ™

The friendly magmeter

MS 2500

FLANGED SENSOR



FLANGED SENSOR WITH A WIDE RANGE OF FLANGE SIZES

Warranty conditions are available on this website:
www.isomag.eu only in English version

ISOIL 
INDUSTRIA
The solutions that count

TECHNICAL DATA

| | |
|-----------------------------|--|
| Body material | <input type="checkbox"/> Carbon steel painted <input type="checkbox"/> Stainless steel AISI 304/316 (opt.) |
| Nominal diameter | <input type="checkbox"/> DN 25 ÷ 2000 |
| Nominal pressure | <input type="checkbox"/> 1600 kPa <input type="checkbox"/> Other on request |
| Process connection | <input type="checkbox"/> Flanges: UNI, ANSI, DIN, JIS <input type="checkbox"/> Other on request |
| Flanges material | <input type="checkbox"/> Carbon steel <input type="checkbox"/> Stainless steel AISI 304- AISI316 (opt.) |
| Liquid temperature | <input type="checkbox"/> 0°C ÷ 60°C with PP lining <input type="checkbox"/> -5°C ÷ 80°C with ebonite lining <input type="checkbox"/> -20°C ÷ 100°C with PTFE lining in compact version <input type="checkbox"/> -20°C ÷ 130°C with PTFE lining in separate version* * Contact the factory for higher temperature |
| Vacuum resistance | <input type="checkbox"/> 20 Kpa (absolute) at 100 °C (60/80°C for PP/Ebonite) |
| Lining material | <input type="checkbox"/> Polypropylene (max. PN 16) <input type="checkbox"/> Ebonite <input type="checkbox"/> PTFE <input type="checkbox"/> Others on request |
| Gasket material | <input type="checkbox"/> Without gasket with lining PTFE and EBONITE <input type="checkbox"/> FPM or EPDM with lining in Polypropylene |
| Electrodes material | <input type="checkbox"/> Stainless steel AISI 316 <input type="checkbox"/> Hastelloy C <input type="checkbox"/> Platinum-rhodium <input type="checkbox"/> Titanium <input type="checkbox"/> Tantalum <input type="checkbox"/> Others on request |
| Version – protection rating | <input type="checkbox"/> Compact version – IP 67 <input type="checkbox"/> Separate version (max 20m) – IP 68 <input type="checkbox"/> Separate version (max 500 m), with preamplifier – IP 67 (OPT. IP 68) |
| Accuracy | <input type="checkbox"/> See table below |

OVERALL DIMENSIONS

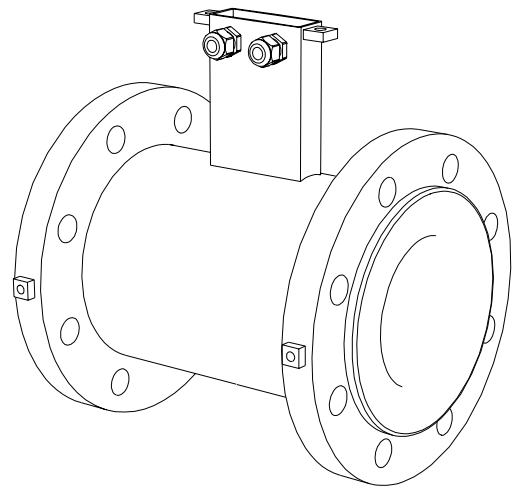
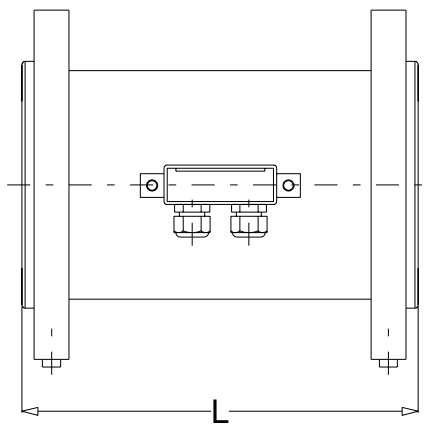
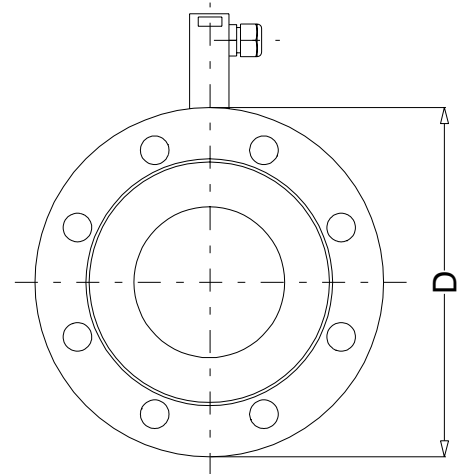
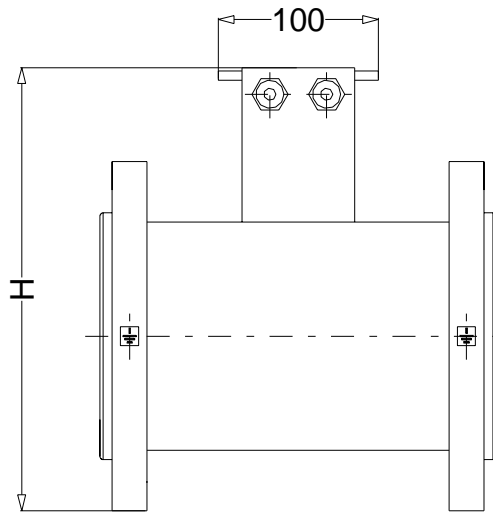

| MS 2500 PN 10/64 - ANSI 150/300 OVERALL DIMENSIONS | | | | | | | | | |
|--|------------|-------------|-------------|-------------|-------------|-------------|-------------|-------------|-------------|
| DIMENSIONS mm (inches) | | PN | | | | | | | |
| | | PN 10 | PN 16 | PN 25 | PN 40 | PN 64 | ANSI 150 | ANSI 300 | |
| DN | 25 (1") | L | 200 (7.87) | 200 (7.87) | 200 (7.87) | 200 (7.87) | 200 (7.87) | 200 (7.87) | 200 (7.87) |
| | | H | 185 (7.28) | 185 (7.28) | 185 (7.28) | 185 (7.28) | 198 (7.80) | 181 (7.13) | 190 (7.48) |
| | | D | 115 (4.53) | 115 (4.53) | 115 (4.53) | 115 (4.53) | 140 (5.51) | 108 (4.25) | 124 (4.88) |
| | 32 (1"1/4) | L | 200 (7.87) | 200 (7.87) | 200 (7.87) | 200 (7.87) | 200 (7.87) | 200 (7.87) | 200 (7.87) |
| | | H | 203 (8) | 203 (8) | 203 (8) | 203 (8) | 209 (8.23) | 192 (7.56) | 199 (7.83) |
| | | D | 140 (5.51) | 140 (5.51) | 140 (5.51) | 140 (5.51) | 155 (6.10) | 118 (4.65) | 133 (5.24) |
| | 40 (1"1/2) | L | 200 (7.87) | 200 (7.87) | 200 (7.87) | 200 (7.87) | 200 (7.87) | 200 (7.87) | 200 (7.87) |
| | | H | 213 (8.39) | 213 (8.39) | 213 (8.39) | 213 (8.39) | 220 (8.66) | 207 (8.15) | 221 (8.7) |
| | | D | 150 (5.90) | 150 (5.90) | 150 (5.90) | 150 (5.90) | 170 (6.69) | 127 (5) | 156 (6.14) |
| | 50 (2") | L | 200 (7.87) | 200 (7.87) | 200 (7.87) | 200 (7.87) | 200 (7.87) | 200 (7.87) | 200 (7.87) |
| | | H | 228 (8.98) | 228 (8.98) | 228 (8.98) | 228 (8.98) | 233 (9.17) | 222 (8.74) | 228 (8.98) |
| | | D | 165 (6.50) | 165 (6.50) | 165 (6.50) | 165 (6.50) | 180 (7.09) | 152 (5.98) | 165 (6.5) |
| | 65 (2"1/2) | L | 200 (7.87) | 200 (7.87) | 200 (7.87) | 200 (7.87) | 200 (7.87) | 200 (7.87) | 200 (7.87) |
| | | H | 248 (9.76) | 248 (9.76) | 248 (9.76) | 248 (9.76) | 257 (10.12) | 245 (9.65) | 251 (9.88) |
| | | D | 185 (7.28) | 185 (7.28) | 185 (7.28) | 185 (7.28) | 205 (8.07) | 178 (7.01) | 191 (7.52) |
| | 80 (3") | L | 200 (7.87) | 200 (7.87) | 200 (7.87) | 200 (7.87) | 200 (7.87) | 200 (7.87) | 200 (7.87) |
| | | H | 263 (10.35) | 263 (10.35) | 263 (10.35) | 263 (10.35) | 267 (10.51) | 259 (10.2) | 268 (10.55) |
| | | D | 200 (7.87) | 200 (7.87) | 200 (7.87) | 200 (7.87) | 215 (8.46) | 191 (7.52) | 210 (8.27) |
| | 100 (4") | L | 250 (9.84) | 250 (9.84) | 250 (9.84) | 250 (9.84) | 250 (9.84) | 250 (9.84) | 250 (9.84) |
| | | H | 283 (11.14) | 283 (11.14) | 294 (11.57) | 294 (11.57) | 297 (11.69) | 288 (11.34) | 300 (11.81) |
| | | D | 220 (8.66) | 220 (8.66) | 235 (9.25) | 235 (9.25) | 250 (9.84) | 229 (9.02) | 254 (10) |
| | 125 (5") | L | 250 (9.84) | 250 (9.84) | 250 (9.84) | 250 (9.84) | 250 (9.84) | 250 (9.84) | 250 (9.84) |
| | | H | 313 (12.32) | 313 (12.32) | 325 (12.80) | 325 (12.80) | 330 (13) | 315 (12.4) | 328 (12.91) |
| | | D | 250 (9.84) | 250 (9.84) | 270 (10.63) | 270 (10.63) | 295 (11.61) | 254 (10) | 279 (10.98) |
| 150 (6") | L | 300 (11.81) | 300 (11.81) | 300 (11.81) | 300 (11.81) | 300 (11.81) | 300 (11.81) | 300 (11.81) | |
| | H | 344 (13.54) | 344 (13.54) | 355 (13.98) | 355 (13.98) | 377 (14.84) | 341 (13.43) | 360 (14.17) | |
| | D | 285 (11.22) | 285 (11.22) | 300 (11.81) | 300 (11.81) | 345 (13.58) | 279 (10.98) | 318 (12.52) | |
| 200 (8") | L | 350 (13.78) | 350 (13.78) | 350 (13.78) | 350 (13.78) | 350 (13.78) | 350 (13.78) | 350 (13.78) | |
| | H | 399 (15.71) | 399 (15.71) | 415 (16.34) | 425 (16.73) | 435 (17.13) | 401 (15.79) | 420 (16.54) | |
| | D | 340 (13.39) | 340 (13.39) | 360 (14.17) | 375 (14.76) | 415 (16.34) | 343 (13.5) | 381 (15) | |
| 250 (10) | L | 450 (17.72) | 450 (17.72) | 450 (17.72) | 450 (17.72) | 450 (17.72) | 450 (17.72) | 450 (17.72) | |
| | H | 454 (17.87) | 460 (18.11) | 475 (18.7) | 493 (19.41) | 491 (19.33) | 461 (18.15) | 480 (18.9) | |
| | D | 395 (15.55) | 405 (15.94) | 425 (16.73) | 450 (17.72) | 470 (18.5) | 406 (15.98) | 445 (17.52) | |
| 300 (12") | L | 500 (19.69) | 500 (19.69) | 500 (19.69) | 500 (19.69) | 500 (19.69) | 500 (19.69) | 500 (19.69) | |
| | H | 504 (19.84) | 515 (20.28) | 535 (21.06) | 558 (21.97) | 545 (21.46) | 527 (20.75) | 546 (21.5) | |
| | D | 445 (17.52) | 460 (18.11) | 485 (19.09) | 515 (20.28) | 530 (20.87) | 483 (19.02) | 521 (20.51) | |
| 350 (14") | L | 550 (21.65) | 550 (21.65) | 550 (21.65) | 550 (21.65) | 550 (21.65) | 550 (21.65) | 550 (21.65) | |
| | H | 564 (22.2) | 575 (22.64) | 598 (23.54) | 619 (24.37) | 603 (23.74) | 582 (22.91) | 607 (23.9) | |
| | D | 505 (19.88) | 520 (20.47) | 555 (21.85) | 580 (22.83) | 600 (23.62) | 533 (20.98) | 584 (22.99) | |
| 400 (16") | L | 600 (23.62) | 600 (23.62) | 600 (23.62) | 600 (23.62) | 600 (23.62) | 600 (23.62) | 600 (23.62) | |
| | H | 620 (24.41) | 630 (24.8) | 659 (25.94) | 695 (27.36) | 670 (26.38) | 639 (25.16) | 664 (26.14) | |
| | D | 565 (22.24) | 580 (22.83) | 62 (2.44) | 660 (25.98) | 670 (26.38) | 597 (23.5) | 648 (25.51) | |
| 450 (18") | L | 600 (23.62) | 600 (23.62) | 600 (23.62) | 600 (23.62) | | 600 (23.62) | 600 (23.62) | |
| | H | 670 (26.38) | 690 (27.17) | 709 (27.91) | 720 (28.35) | | 688 (27.09) | 726 (28.58) | |
| | D | 615 (24.21) | 640 (25.2) | 670 (26.38) | 685 (26.97) | | 635 (25) | 711 (27.99) | |
| 500 (20") | L | 600 (23.62) | 600 (23.62) | 600 (23.62) | 600 (23.62) | | 600 (23.62) | 600 (23.62) | |
| | H | 725 (28.54) | 758 (29.84) | 769 (30.28) | 784 (30.87) | | 751 (29.57) | 770 (30.31) | |
| | D | 670 (26.38) | 715 (28.15) | 730 (28.74) | 755 (29.72) | | 699 (27.52) | 775 (30.51) | |

| MS 2500 PN 10/64 - ANSI 150/300 OVERALL DIMENSIONS | | | | | | | | | |
|--|------------|--------------|--------------|--------------|--------------|--------------|----------------|----------------|--------------|
| Dimensions | mm(inches) | PN | | | | | | | |
| | | PN 10 | PN 16 | PN 25 | PN 40 | PN 64 | ANSI 150 | ANSI 300 | |
| DN | 600 (24") | L | 600 (23.62) | 600 (23.62) | 600 (23.62) | 600 (23.62) | | 600 (23.62) | 600 (23.62) |
| | | H | 830 (32.68) | 879 (34.61) | 880 (34.65) | 911 (35.87) | | 866 (34.09) | 916 (36.06) |
| | | D | 780 (30.71) | 840 (33.07) | 845 (33.27) | 890 (35.04) | | 813 (32.01) | 914 (35.98) |
| | 650 (26") | L | | | | | | 650 (25.59) | 650 (25.59) |
| | | H | | | | | | 921 (36.26) | 1002 (39.45) |
| | | D | | | | | | 870 (34.25) | 972 (38.27) |
| | 700 (28") | L | 700 (27.56) | 700 (27.56) | 700 (27.56) | 700 (27.56) | | 700 (27.56) | |
| | | H | 895 (35.24) | 949 (37.36) | 989 (38.94) | 1016 (40) | | 1016 (40) | |
| | | D | 800 (31.5) | 910 (35.83) | 960 (37.8) | 995 (39.17) | | 927,1 (36,5) | |
| | 750 (30") | L | | | | | | 750 (29.53) | 750 (29.53) |
| | | H | | | | | | 1032 (40.63) | 1121 (44.13) |
| | | D | | | | | | 984 (38.74) | 1092 (42.99) |
| | 800 (32") | L | 800 (31.5) | 800 (31.5) | 800 (31.5) | 800 (31.5) | | 800 (31.5) | |
| | | H | 1058 (41.65) | 1060 (41.73) | 1106 (43.54) | 1149 (45.24) | | 1149 (45.24) | |
| | | D | 1015 (39.96) | 1025 (40.35) | 1085 (42.72) | 1114 (43.86) | | 1060,5 (47,15) | |
| | 850 (34") | L | | | | | | 850 (33.46) | 850 (33.46) |
| | | H | | | | | | 1149 (45.24) | 1230 (48.43) |
| | | D | | | | | | 1111 (43.74) | 1207 (47.52) |
| | 900 (36") | L | 900 (35.43) | 900 (35.43) | 900 (35.43) | 900 (35.43) | | 900 (35.43) | 900 (35.43) |
| | | H | 1158 (45.59) | 1160 (45.67) | 1206 (47.48) | 1259 (49.57) | | 1206 (47.48) | 1292 (50.87) |
| | | D | 1115 (43.9) | 1125 (44.29) | 1185 (46.65) | 1250 (49.21) | | 1168 (45.98) | 1270 (50) |
| | 1000 (40") | L | 1000 (39.37) | 1000 (39.37) | 1000 (39.37) | 1000 (39.37) | | 1000 (39.37) | 1000 (39.37) |
| | | H | 1269 (49.96) | 1284 (50.55) | 1329 (52.32) | 1369 (53.9) | | 1381 (54.37) | 1467 (57.76) |
| | | D | 1230 (48.43) | 1255 (49.41) | 1320 (51.97) | 1360 (53.54) | | 1346 (52.99) | 1448 (57.01) |
| 1050 (42") | L | | | | | | 1050 (41.3) | | |
| | H | | | | | | 1355.0 (54.00) | | |
| | D | | | | | | 1346.2 (53.00) | | |
| 1100 (44") | L | | | | | | 1100 (43.3) | | |
| | H | | | | | | 1428 (56.25) | | |
| | D | | | | | | 1403.4 (55.25) | | |
| 1200 (48") | L | 1200 (47.24) | 1200 (47.24) | | | | 1200 (47.24) | | |
| | H | 1498 (59.92) | 1518 (59.76) | | | | 1530 (60.50) | | |
| | D | 1455 (57.28) | 1485 (58.46) | | | | 1511.3 (59.50) | | |
| 1400 (56") | L | 1400 (55.18) | 1400 (55.18) | | | | | | |
| | H | 1711 (67.36) | 1714 (67.46) | | | | | | |
| | D | 1675 (65.94) | 1685 (66.34) | | | | | | |
| 1600 (56") | L | 1600 (62.99) | 1600 (62.99) | | | | | | |
| | H | 1944 (76.52) | 1947 (76.65) | | | | | | |
| | D | 1915 (75.39) | 1930 (75.98) | | | | | | |
| 1800 (72") | L | 1800 (70.87) | 1800 (70.87) | | | | 1800 (72.00) | | |
| | H | 2144 (84.39) | 2147 (84.53) | | | | 2190 (54.37) | | |
| | D | 2115 (83.27) | 2130 (75.98) | | | | 2197 (86.50) | | |
| 2000 (80") | L | 2000 (78.74) | 2000 (78.74) | | | | | | |
| | H | 2352 (92.66) | 2356 (92.77) | | | | | | |
| | D | 2325 (91.53) | 2345 (92.32) | | | | | | |

TORQUES (Nm)

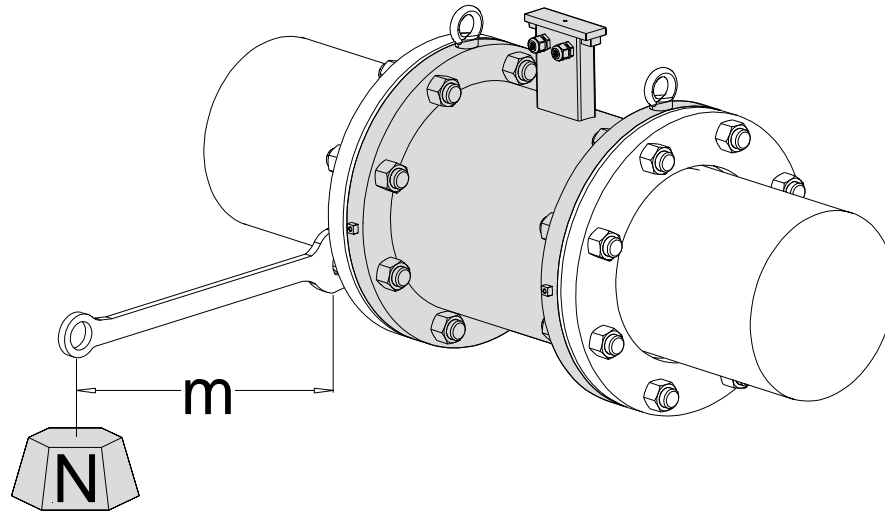

| OPERATIVE PRESSURE | | | | | | | | | | |
|--------------------|------|-------|--------------|--------------|------|------|-------|--------------|--------------|--------------|
| Kpa | 1000 | | 1600 | | 2500 | | 4000 | | 6400 | |
| psi | 140 | | 260 | | 350 | | 600 | | 1000 | |
| DN | PTFE | EBON. | PTFE | EBON. | PP | PTFE | EBON. | PTFE | EBON. | EBON. |
| 25 | | | 25 (21) | | 19 | 25 | | 25 [32] | | 39 [32] |
| 32 | | | 43 (26) | | 28 | 43 | | 43 [40] | | 53 [40] |
| 40 | | | 53 (32) | | 36 | 53 | | 53 [63] | | 72 [63] |
| 50 | | | 68 (60) | | 52 | 68 | | 68 [35] | | 81 [35] |
| 65 | | | 90 (78) | | 75 | 45 | | 45 [53] | | 58 [53] |
| 80 | | | 53 (89) | | 41 | 53 | | 53 [68] | | 62 [68] |
| 100 | | | 59 (70) | | 56 | 83 | | 83 [94] | | 87 [94] |
| 125 | | | 77 (94) | | 71 | 112 | | 112 [130] | | 148 [130] |
| 150 | | | 108 (106) | | 106 | 135 | | 135 [113] | | 217 [113] |
| 200 | 148 | 123 | 99 (148) | 82 (124) | | 134 | 112 | 178 [178] | 149 [148] | 233 [178] |
| 250 | 123 | 103 | 140 (156) | 117 (130) | | 204 | 170 | 267 [185] | 223 [154] | 321 [185] |
| 300 | 142 | 119 | 175 (234) | 146 (195) | | 201 | 168 | 278 [275] | 232 [229] | 317 [275] |
| 350 | 172 | 143 | 205 (325) | 171 (271) | | 324 | 270 | 422 [318] | 352 [265] | 481 [318] |
| 400 | 217 | 181 | 282 (312) | 235 (260) | | 426 | 355 | 619 [411] | 516 [342] | 623 [411] |
| 450 | 194 | 161 | 281 (336) | 234 (280) | | | | [398] | [332] | |
| 500 | 224 | 186 | 382 (317) | 318 (264) | | | | [465] | [387] | |
| 550 | | | (379) | (316) | | | | [608] | [506] | |
| 600 | 323 | 269 | 568 (463) | 474 (386) | | | | [774] | [645] | |
| 650 | | | (429) | (357) | | | | [753] | [627] | |
| 700 | 356 | 297 | 421 (503) | 351 (420) | | | | [947] | [789] | |
| 750 | | | (451) | (376) | | | | [1105] | [920] | |
| 800 | 476 | 400 | 549 | 446 | | | | | | |
| 850 | | | (563) | (469) | | | | [1373] | [1144] | |
| 900 | 450 | 380 | 519 (618) | 395 (515) | | | | [1408] | [1173] | |
| 1000 | 582 | 485 | 721 (736) | 546 (613) | | | | [1598] | [1332] | |

- Tighten uniformly in diagonally opposite sequence
- The torque listed in tab are applicable to flanges: EN1092-1, DIN 2501, BS 4504, ANSI B16.5 , JIS
- The use of DIN 2690 gaskets is recommended
- For DN > 1000 contact the manufacturer
- Value between curved brackets (xxxx)= ANSI 150
- Value between squared brackets [xxxx]= ANSI 300

INSTALLATION RECOMMENDATIONS

In vertical installations an ascending flow is preferable. For vertical installations with descending flow direction contact the manufacturer

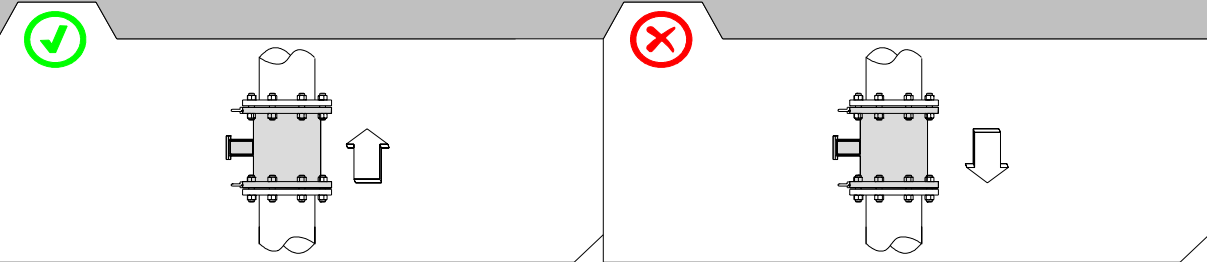

For installations in long pipe lines, please use anti vibration joints

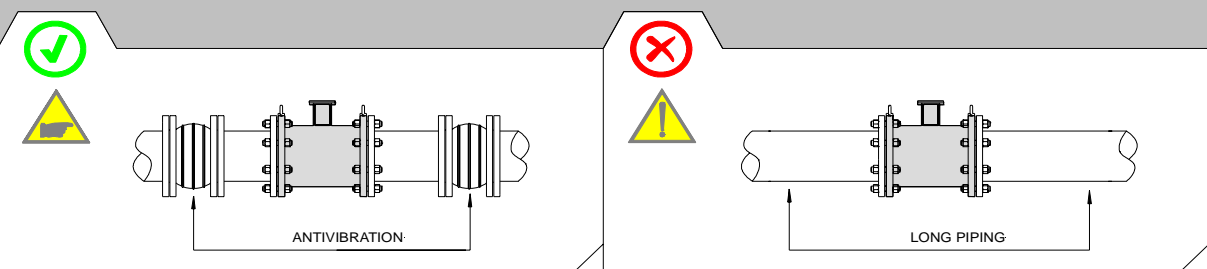

Avoid a partially empty pipe, during operation the pipe must be either completely full of liquid or completely empty

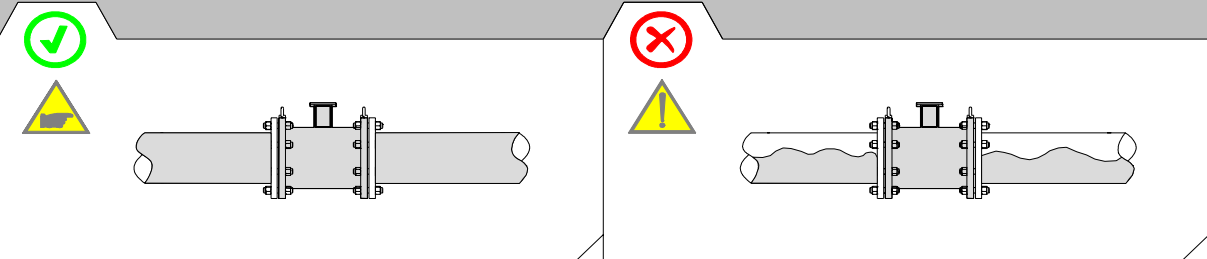

Install the sensor away from bends and hydraulic accessories

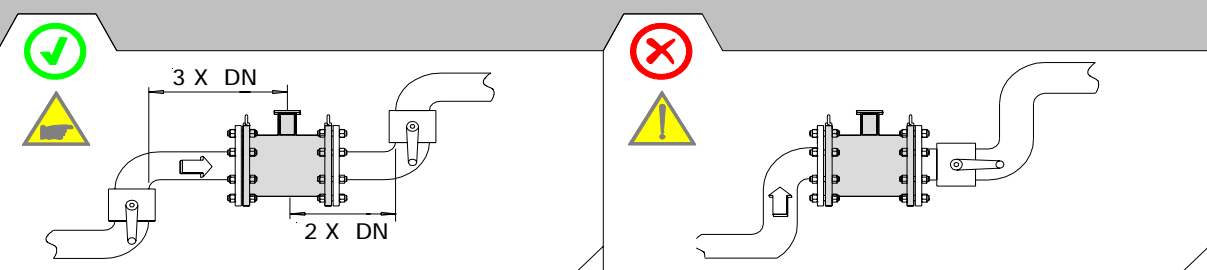

Avoid positioning flange and counter flanges by tightening the nuts.

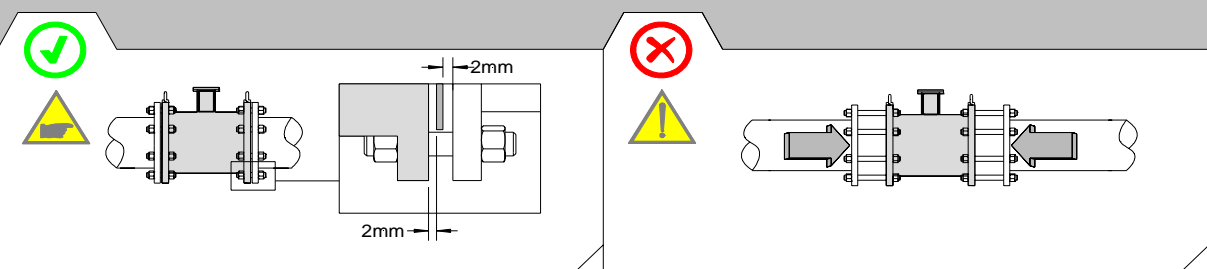

RECOMMENDED INSTALLATION METHOD

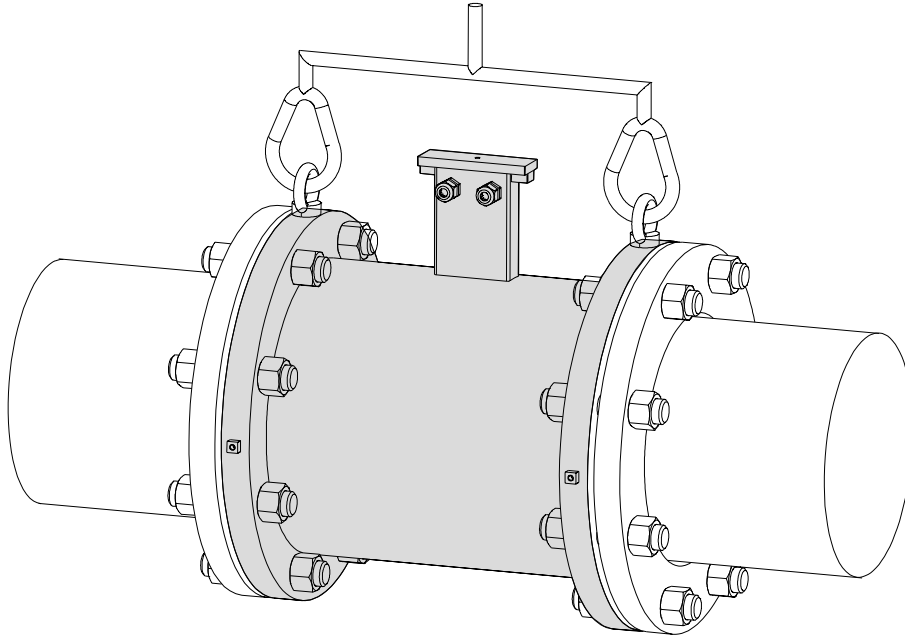

Sensors weighing above 20Kg are equipped of appropriate eyebolts to lift the sensor in to place according to the above illustrated method

- The eyebolts support the only weight of the meter.

SENSOR GROUNDING

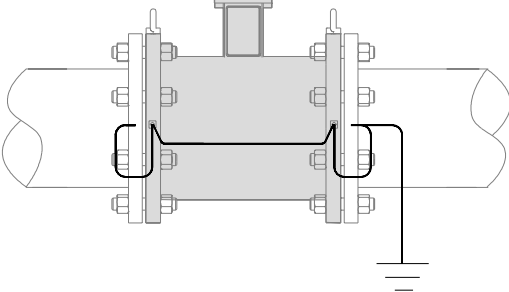
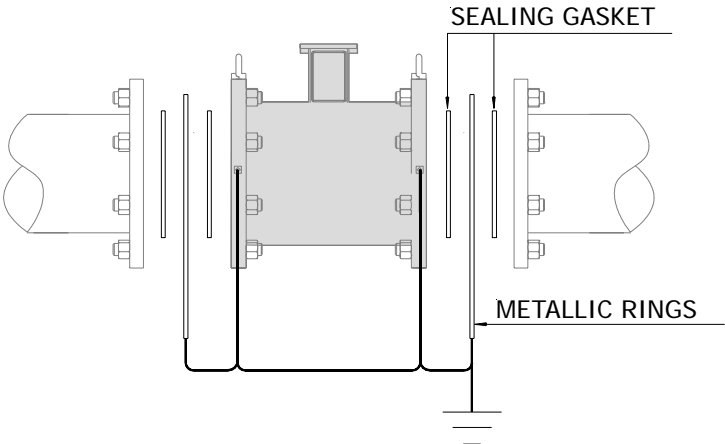
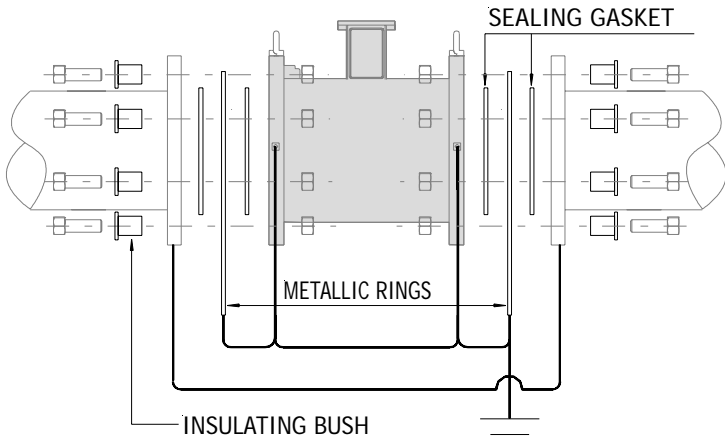
| METALLIC PIPE | |
|---|---|
|  | |
| INSULATED PIPE | |
|  | <p>-If the sensor has to be installed in a pipe made of an insulating material, the following are necessary:</p> <ul style="list-style-type: none"> - Inserting two metallic rings between the sensor flanges and the pipe line counter flanges <p>or</p> <ul style="list-style-type: none"> - Using a sensor with the additional grounding electrode |
| PIPE WITH CATHODIC PROTECTION | |
|  | <p>If the sensor has to be installed in the pipe with a cathodic protection, the following are necessary:</p> <ul style="list-style-type: none"> - using insulating bushes to isolate the bolts - Metallic grounding rings should be provided to ground the liquid using insulating gasket between the rings |

ACCURACY TABLE

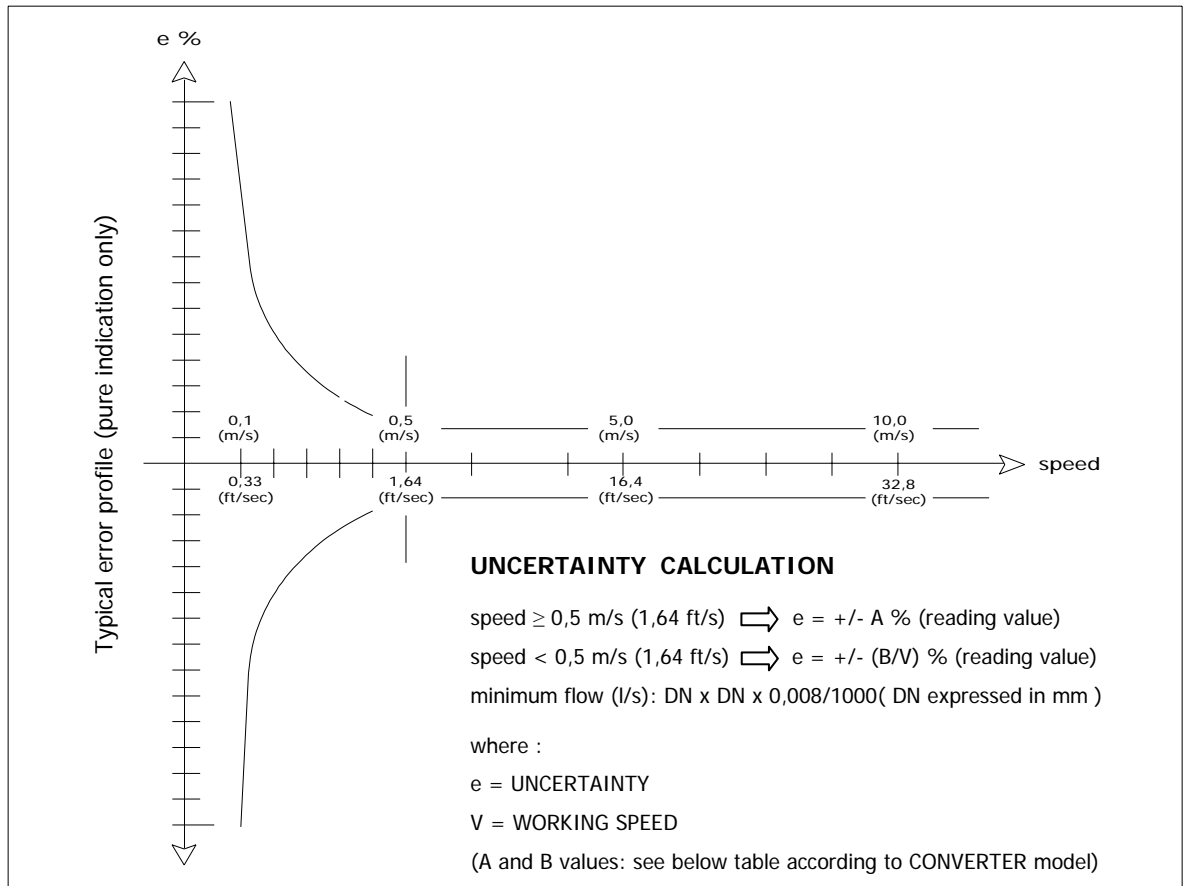

AC/DC POWERED CONVERTERS

| ML 51 | | | ML 110 – STD | | | ML 110 – SA* | | | ML210/211/212 | | | ML4F1 | | |
|-------|---------|----------|--------------|---------|----------|--------------|---------|----------|---------------|---------|----------|-------|---------|----------|
| A | B (m/s) | B (ft/s) | A | B (m/s) | B (ft/s) | A | B (m/s) | B (ft/s) | A | B (m/s) | B (ft/s) | A | B (m/s) | B (ft/s) |
| 0,5 | 0,25 | 0,82 | 0,8 | 0,4 | 1,31 | 0,4 | 0,2 | 0,66 | 0,2 | 0,1 | 0,33 | 0,2 | 0,1 | 0,33 |

* SPECIAL ACCURACY

FLOWIZ™ BATTERY POWERED CONVERTERS

| ML 250 | | | ML 252 | | |
|--------|---------|----------|--------|---------|----------|
| A | B (m/s) | B (ft/s) | A | B (m/s) | B (ft/s) |
| 0,5 | 0,25 | 0,82 | 0,5 | 0,25 | 0,82 |

Reference conditions :

- Constant flow rate during the test
- Pressure: >30 Kpa
- Flow condition : fully developed flow profile
- Zero stability +/- 0,005 %

HOW TO ORDER

| | |
|--|---|
| MS 2500 | Nominal Diameter / Lining / Liquid temperature / Measuring range |
| T25 + T1200 | From ND 25 (1") up to ND 1200 (48"), PTFE lining, liquid maximum temperature 150 °C, Measuring range 0...0.72/0...40000 m3/h |
| P25 + P150 | From ND 25 (1") up to ND 150 (6"), Polypropilene lining, liquid maximum temperature 60 °C, Measuring range 0...0.72/0...640 m3/h |
| E200+E2000 | From ND 200 (8") up to ND 2000 (80"), Ebonite lining, liquid maximum temperature 80 °C, Measuring range 0...45.2/0...640 m3/h |
| Gasket material (Internal tightness, only for polypropilene lining) | |
| A | No O-Ring (ONLY FOR PTFE/EBANITE LINING) |
| B | O-Ring : FPM |
| C | O-Ring : Epdm |
| Z | Other O-Ring |
| Flanges type | |
| 1 | Flanges UNI2223 PN16 (max. with Polypropilene lining) |
| 2 | Flanges UNI2223 PN10 |
| 3 | Flanges UNI2223 PN25 |
| 4 | Flanges UNI2223 PN40 (standard for DN 25 ...50 with PTFE lining) |
| 5 | Flanges UNI2223 PN64 |
| 6 | Flanges ANSI 150RF |
| 7 | Flanges ANSI 300RF |
| 8 | Flanges PN6 |
| 9 | Flanges JIS 10K |
| 0 | Flanges: to be specified |
| Body material | |
| A | Body and flange in Carbon Steel, RAL6028 painted |
| B | Body and flange in Stainless Steel (AISI304) |
| C | Body and flange in Stainless Steel (AISI316) |
| Z | Body and flange material: other |
| Number and electrodes material | |
| 1 | n. 2 measure electrodes in AISI316 |
| 2 | n. 3 (2 measure + 1 for ground) electrodes in AISI316 |
| 4 | n. 3 (2 measure + 1 for ground) electrodes in Hastelloy C |
| 5 | n. 3 (2 measure + 1 for ground) electrodes in Titanium |
| 6 | n. 3 (2 measure + 1 for ground) electrodes in Tantalum; not available with Polypropilene |
| 7 | n. 3 (2 measure + 1 for ground) electrodes in Platinum; not available with Polypropilene |
| 0 | da specificare/other |
| Version - Protection rate | |
| A | Compact version, IP67 protection rate, liquid maximum temperature 100 °C |
| B | Separate version "C", maximum length 10 m (20m, see note 1), liquid maximum temperature 150 °C, protection rate IP68 |
| C | Separate version "L" (in Carbon Steel), with preamplifier (maximum length 500 m), liquid maximum temperature 100 °C, protection rate IP67 (option IP68) |
| D | Separate version "L" (in AISI304), with preamplifier (maximum length 500 m.), liquid maximum temperature 100 °C, protection rate IP67 (option IP68) |
| E | Version with neck of the Sensor according to draw. G006 (valid for A-B-C-D versions, add the relative COST) |
| F | Separate version with N° 2 connectors IP 68 suitable for C015/16 (max 20 m-ADD THE COST) |
| G | Separate version with N° 1 connectors IP 68 suitable for C018 (max 20 m-ADD THE COST) |
| H | Separate vers. with N° 1 connectors IP 68 suitable for C014 for fast cable connections TO PREAMP. IN CAR. STEEL(DEFINE THE CABLE LENGHT MAX 500 m-ADD THE COST) |
| I | Separate vers. with N° 1 connectors IP 68 suitable for C014 for fast cable connections TO PREAMP. IN SS (DEFINE THE CABLE LENGHT MAX 500 m-ADD THE COST) |
| M | Compact version, IP67 protection rate , with the possibility to turn the converter 90° |

MS 2500 T25 A 4 A 1 A EXAMPLE OF CODE FOR ORDER

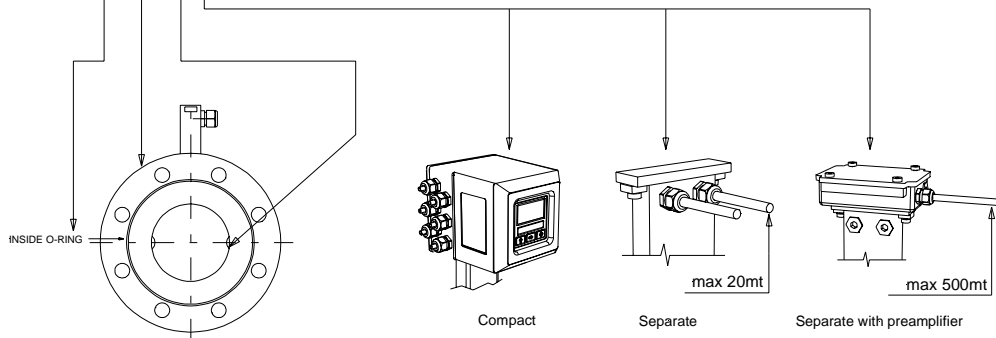

The manufacturer reserves the right to make design improvements without notice.